

KAMAKASA



KAMAKASA

Asking price

EUR 24,900,000

Built

2020, Sanlorenzo, Italy

Length

44.5m (146ft)

Beam

9m (29.5ft)

Draft

2.3m (7.5ft)

Gross Tonnage

483

Cruising speed

18 knots

Maximum speed

21 knots

Range

2,000 nm

Flag

Cayman Islands

Lying

West Mediterranean

Class

ABS

Exterior Designer

Zuccon International Project

Interior Designer

Zuccon International Project/Laura Pomponi

Construction

Hull - Aluminium, Superstructure - Aluminium, Deck - Teak

Crew

9

Guests

11

Cabins

5 cabins (4 x double, 1 x twin, 1 x additional berths)

Engines

2 x 2,636hp MTU

Propulsion

Twin screw diesel yacht

Notes

Not available for sale to US residents while in US waters

KAMAKASA

About

The 44.5m (146ft) KAMAKASA is the second hull in the Anlorenzo 44 Alloy Series. She has full aluminium construction and is built to ABS classification with naval architecture by the shipyard. Her contemporary exterior are by Zucon International Project and with a beam of 9.3m she offers 483GT of interior volume who is calling design by Zucon International Design.

Considerable deck space include the main deck with sun lounging aft, a lounge area, dining table, bar and another bank of sunpads forward. On a spacious upper deck aft there is more sunbathing aft and a second open-air dining option on a veritable deck space shaded by the overhang. Folding glass doors lead into a lounge with full-height glass and to the bank of sofas eating with a large TV on the forward bulkhead. Glazed bulkheads deliver exceptional views. Walkaround deck leads forward to a private owner's area on the foredeck complete with lounge, eating and a jacuzzi nestled among a raft of sunpads.

Lower deck leads down to the main lounge with access to the deck and a dayhead. Aft is the formal dining space and there is an open plan lounge aft of that. Full-height folding glass doors aft and either side combine with glazed bulkheads to bring the outside in. On the main deck aft is a lounge area partially shaded by the upper deck overhang, and a bank of sunpads. Steps lead down to the swim platform and each club to which there is also internal access. The teak-decked each club is a multipurpose space that features a bar, lounge and gym and the space is open on three sides with a swim platform aft and sea terrace port and starboard. The space is also a tender and to garage, launching to starboard on horizontal davit.

She accommodates 11 guests in five cabins. The owner's suite is split level. From the main lounge a door opens into a private study and steps lead up to the owner's lounge and down into the bedroom suite. The full-beam owner's suite has a hi-ceiling and a bathroom forward and a walk-in wardrobe. The lounge has a drop-down TV and exceptional views across the owner's foredeck jacuzzi and eating area, to which there is also private access. On the lower deck are three double bunks and one twin bunk with an additional berth.

Alongside the main tender in the each club there is a tender and to storage behind a main deck hull door to port. The 2,636hp MTU diesel engine give her a top speed of 21 knots, the cruise at 18 knots and has a maximum range of 2,000nm. Zero speed stabilisers ensure comfort at anchor on arrival.

Key features

Exceptional three-level full beam owner's suite with private owners mezzanine and forward views

Private owner's bridge deck forward jacuzzi

Beach club with gym and folding sea terraces

Spacious outside lounge and dining areas

Sleeps 11 guests in 5 elegantly appointed cabins

Garage space for 7 metre tender



Main Cabin



Main Cabin



Main Salon



Main deck dining



Maier ca



Maier ca



Maier cabin en suite



Maier ca in ardor



Other office



Other office



Other office



Ober' lounge



Ober lounge



Gueca



Gueca en lite



Gueca



Gue ca in



Gueca



☐☐ lounge



Main deck aft



☐idge deck aft



Edge deck for Card

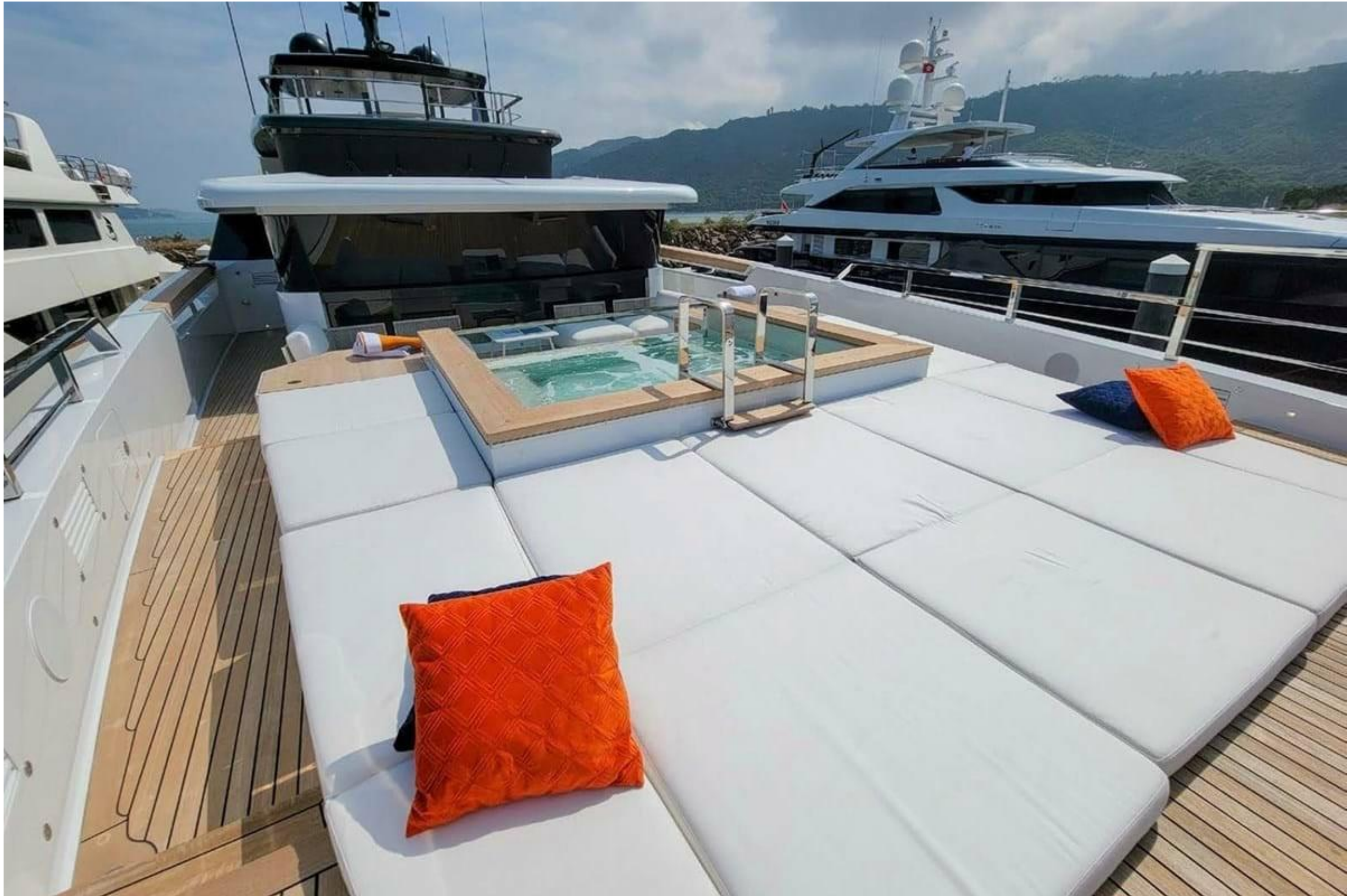

Edge deck for Card



Edge deck for hard jacuzzi



Edge deck for Card



▣idge deck aft dining



☐ In deck



Deck for Card



□ In deck



□ In deck



in deck aft



□ridge

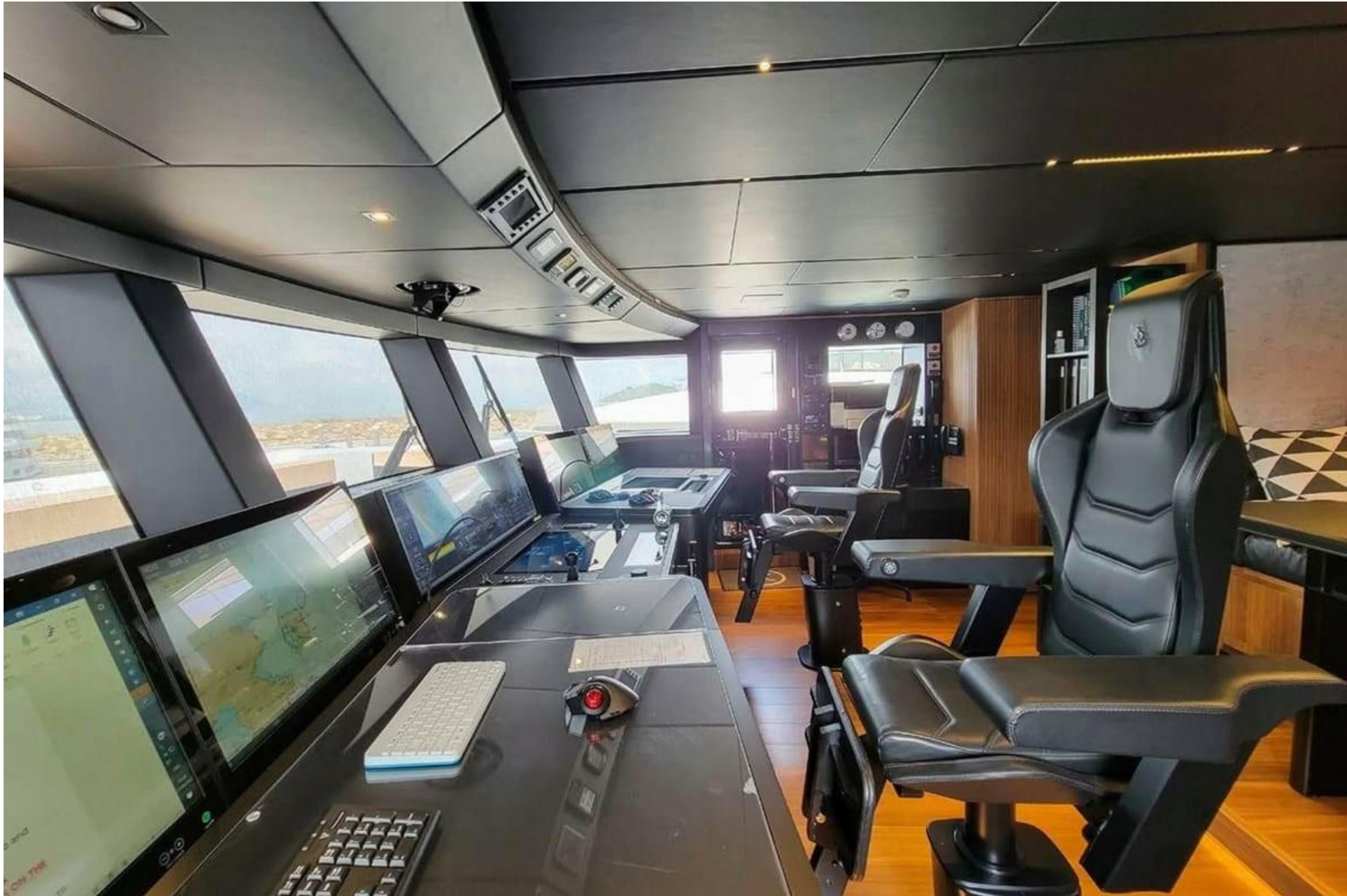

□ridge



Galle



Cruising

SUN DECK

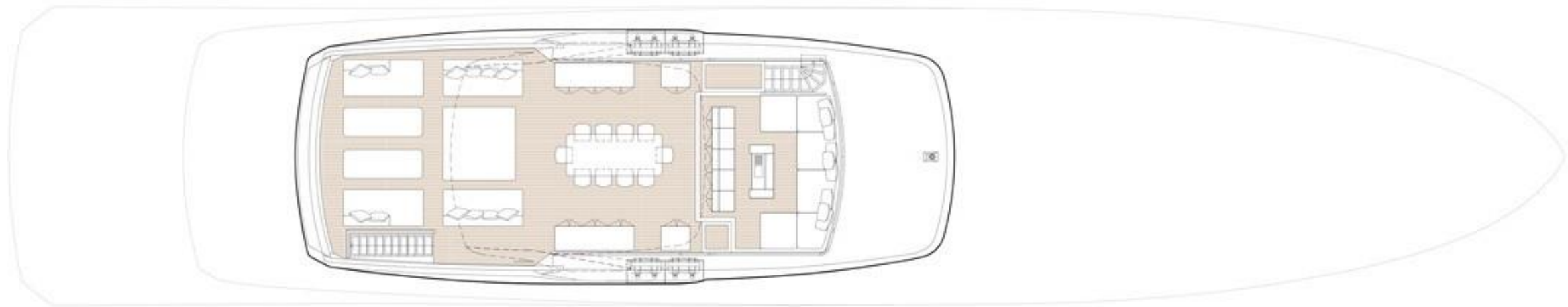

- GUEST AREAS
- MASTER SUITE
- VIP SUITE
- GUEST CABINS
- MASTER SUITE OFFICE
- POOL

☐ in deck

UPPER DECK



■ GUEST AREAS ■ MASTER SUITE ■ VIP SUITE ■ GUEST CABINS ■ MASTER SUITE OFFICE ■ POOL

Upper deck

MAIN DECK



■ GUEST AREAS ■ MASTER SUITE ■ VIP SUITE ■ GUEST CABINS ■ MASTER SUITE OFFICE ■ POOL

Main deck

LOWER DECK

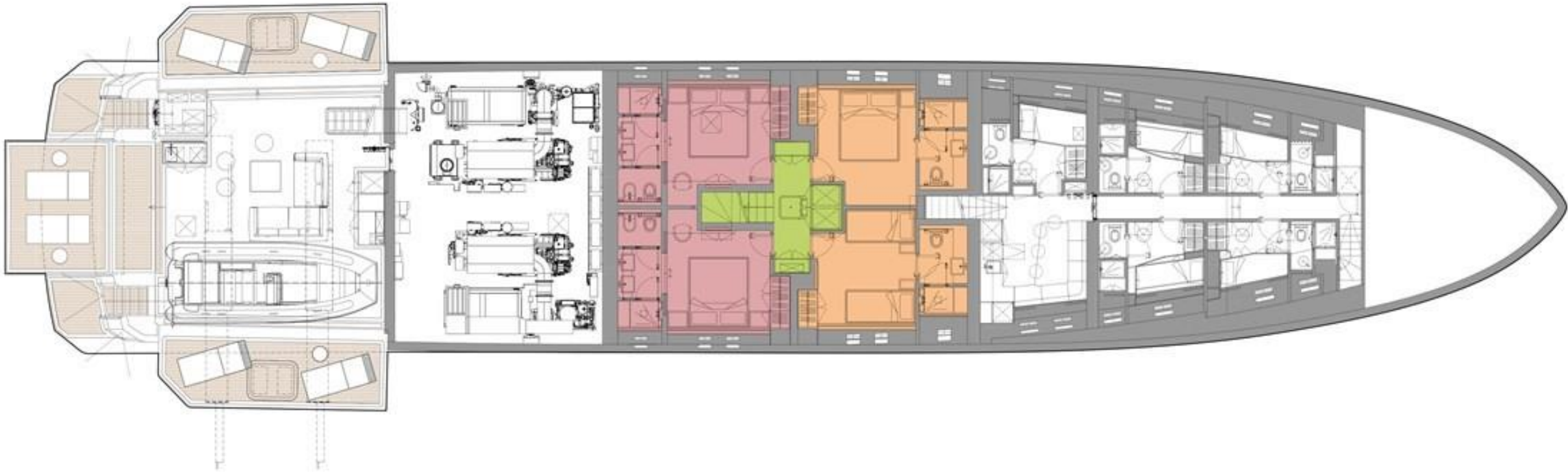

- GUEST AREAS
- MASTER SUITE
- VIP SUITE
- GUEST CABINS
- MASTER SUITE OFFICE
- POOL

Lower deck