

NADAN



LOA:	151' 3" (46.1m)	Delivery/Model	2009
Beam:	26' 5" (8.05m)	Year:	
Max Draft:	6' (1.83m)	Builder:	BURGER
Tonnage:	271.00	Type:	Motor Yacht
Speed:	12 Knots 14 Knots	Staterooms:	4
Flag:	Jamaica	Fuel Cap:	16161 L (4269.28 Gal)
Location:	Cruising to N/A, N/A The Bahamas	Water Cap:	5680 L (1500.5 Gal)
VAT Paid:		Engines:	2x, Caterpillar, C18, 601 HP
		Price:	\$22,500,000 USD

Additional Specifications For NADAN:

LOA:	151' 3" (46.1m)	Delivery/Model	2009
Beam:	26' 5" (8.05m)	Year:	
Max Draft:	6' (1.83m)	Year Built:	2009
Hull Material:	Aluminum	Refit Year:	2019
Superstructure:	Aluminum	Builder:	BURGER
Hull Designer:	Burger Boat Company / Bruce King Yacht Design (USA)	Type:	Motor Yacht
Deck Material:	Teak	Engines:	601 HP, Twin, Diesel, Caterpillar, C18,
Tonnage:	271.00	Staterooms:	4
Range At Cruise	1700	Sleeps:	9
Speed:		Captain Cabin:	No
Range At Max	1150	Classifications:	American Bureau of Shipping Maltese Cross A1, Yachting Service, AMS
Speed:	Cruising 12 Knots Max 14 Knots	MCA: ISM:	
Int Designer:	Burger Boat Company / Ken Freivokh Design (USA)		
Ext Designer:	Burger Boat Company		
Fuel Capacity:	16161 L (4269.28 Gal)		
Water Capacity:	5680 L (1500.5 Gal)		
Flag:	Jamaica		
Location:	N/A, N/A The Bahamas		
Price:	\$22,500,000 USD		

DETAILED DESCRIPTION

1. **MAIN CHARACTERISTICS**

TYPE	Motor Yacht
HULL NO.	500
MMSI	339127000
BUILDER	Burger Boat Company (USA)
NAVAL ARCHITECT	Burger Boat Company / Bruce King Yacht Design (USA)
EXTERIOR DESIGN	Burger Boat Company
INTERIOR DESIGN	Burger Boat Company / Ken Freivokh Design (USA)
YEAR	2021 / 2019 upgrades / 2009
CLASSIFICATION	ABS Maltese Cross A1, Yachting Service, AMS
CONSTRUCTION	Aluminum alloy hull (in 5 x watertight compartments) Aluminium superstructure, Teak decks
CREW	7
FLAG	Jamaica
ENGINES	2 x 600 Hp Caterpillar C18 Diesel
GT	271
NT	81
DISPLACEMENT	216 long tons fully loaded

2. **DIMENSIONS**

LOA	46.10m / 151'3"
BEAM	8.05m / 26'5"
DRAFT	1.83m / 6'0"

3. **SPEED & RANGE UNDER POWER**

MAXIMUM SPEED	14 knots using 52USG-196 l/h @ 1,850 rpm – 1,150nm
CRUISING SPEED	12 knots using 30USG -113 l/h @ 1,500rpm – 1,700nm
ECONOMICAL SPEED	10 knots using 18USG-68 l/h @ 1,200 rpm – 2,400nm
RANGE	2,400nm @ 10 knots

4. **CAPACITIES**

ACCOMMODATION	8+1 x Guests in 4 cabins, 1 x Pullman berth
CREW	7 x Crew in 4 cabins
FUEL	16,161 litres / 4,270 US gallons
FRESH WATER	5,680 litres / 1,500 US gallons
CLEAN OIL	450 litres / 120 US gallons
WASTE OIL	450 litres / 120 US gallons
GREY & BLACK WATER	2,120 litres / 560 US gallons

Generated On 7/3/2023 9:10 AM by RoyalYacht Service

5. ACCOMMODATION

OVERVIEW	NADAN sleeps 9 in the Owner's party in 4 cabins with one Pullman berth, plus crew accommodations for up to 7 in 4 cabins (including Captain's Cabin).
BRIDGE DECK	Sky lounge with en-suite toilet.
MAIN DECK	Owner's Cabin on the main deck with king size bed and en-suite bathroom. Main Salon & Dining with veranda.
LOWER DECK	1 x VIP Guest Cabin – full beam aft with king berth and en-suite bathroom. 1 x Double Guest Cabin – with queen size berth and en-suite bathroom. 1 x Twin Guest Cabin – with twin berths plus one Pullman berth and en-suite bathroom.
CREW	4 x crew cabins (including Captain's Cabin) forward on the lower deck. Each cabin has an en-suite toilet and shower.

6. VESSEL WALKTHROUGH

From the moment one boards NADAN they are transported back in time to the elegance and luxury reminiscent of yachting in the Art Deco era. The exterior styling incorporates the teak and white painted panelling typical of this time period and invites you in to experience the full impact of its interior spaces.

One of the first things you notice is the beautifully detailed Madrone Burl raised wall panels enhanced with inlaid Macassar Ebony and accented with Padauk moulding. The door surrounds and featured cabinet pieces are exquisitely adorned with polished stainless steel detailing which, in addition to the jewellery quality door hardware, adds a touch of glamour throughout.

The Main Salon features a grouping of lounge furniture arranged for conversation. As a complement to this entertainment space there is a curved, leather upholstered bar with custom crafted stainless steel bar stools. A coffee table sits beneath a circular skylight.

The adjoining Dining Salon is a completely separate, private space. The curved walls with doors of this space feature Lalique glass panels and echo the shape of the dining table and cause the room to focus on the full-length French doors which allow access to the exterior, where a section of the bulwark lowers to form a veranda. This feature fully opens this room to views of the water.

The Main Deck Owner's Suite generously accommodates the king size bed which is crowned with a lavish fully upholstered headboard set against a room expanding wall of mirror. An accent to the room is the Owner's desk with inlaid leather top.

The three guest cabins and baths share the same level of luxury and quality of detail as established in the main deck living areas of the vessel.

The Captain and Crew cabins continue the elegance of the Art Deco era with white painted tongue and groove panel walls and contrasting Mahogany beams, raised panel doors and trim. This area includes the Main Galley and Crew Lounge/Mess and Laundry facility. The built-in furniture and cabinetry throughout this area is also Mahogany in a simpler style that incorporates the use of polished chrome accents in the hardware that was selected specifically for these areas. The use of the cream and blue color scheme creates a continuous flow of colour throughout the entire vessel. The crew may access the guest cabins via the engine room.

After the present owner took over her stewardship, a private Owner’s Lounge was added to the sundeck. This unique observation/lounge/office space is the perfect get away, featuring wood panelling, unobstructed views and private head. Doors on either side open directly to the sundeck.

7. MECHANICAL EQUIPMENT

ENGINES	2 x 448 kW (601 Hp) Caterpillar C18 Diesel (@2,100 rpm)
ENGINES HOURS	Port: 5,735 hours as of 14th Oct 2022 Starboard: 5,738 hours as of 14th Oct 2022
GENERATORS	2 x 65 kW (87 Hp) Kohler 60Hz 208V 3-phase
GENERATORS HOURS	Port: 12,864 hours as of 14th Oct 2022 Starboard: 12,662 hours as of 14th Oct 2022
STABILISERS	Quantum At Anchor
STERNTHRUSTER	Quantum QT30 12.5” 4-blades SS, 35 Hp
BOWTHRUSTER	1 x Quantum QT120 21” 4-blade SS, 116 Hp
ENGINE CONTROLS	2 x Kobelt Stations 3 x Kobelt Barracuda remotes
STEERING SYSTEM	1 x Jastram hydraulic power steering
GEARBOXES	Reintjes WAF 244, 2.539:1 reduction ratio
SHAFTS	2 x Aquamet 22HS, 4” diam
PROPELLERS	2 x Michigan Wheels CX500DAR, 36” x 41”, 5-blades
STABILIZERS	2 x Fin Quantum Marine QC 1000 active fin, at anchor Quantum Power Pack with 2 x 20Hp motors, 2 x 45cc pumps
STERN THRUSTER	1 x Quantum QT30 12.5” 4-blade SS, 35 Hp
ELECTRICITY	208V/120V 3-phase 60 Hz
SHORE POWER	Asea converter Input: 175/520V 40-70 Hz Output: 208/120V 3-phase 60 Hz 75 KVA
BATTERIES	2 x 8D banks for M/E, interchangeable 1 x 8D battery for radio and 1 x 8D battery for navigation 6 x 8D emergency batteries 2 x 8D Batteries for generator and house, interchangeable
AIR CONDITIONING	Dometic central chilled 360,000 BTU/30kW Heating 4 x Compressors 2 x Make-Up Air Units 36,000 BTU 21 x Fan Coils

Generated On 7/3/2023 9:10 AM by RoyalYacht Service

AIR COMPRESSOR	Powerex 7.6 CFM @ 145 PSI
VENTILATION	Delta-T Systems with 2 x reversible, variable speed axial fans in E/R
WATER MAKER	1 x Matrix S-2600 reverse osmosis desalination @ 9,842 l / 2,600 USG/day
FRESH WATER MAKER	1 x Matrix Silver B System, 3600 GPD reverse osmosis, 3 x membranes
FRESH WATER PRESSURE	2 x Grundfos MQ345 1Hp pumps
HOT WATER	1 x Nibe SP-200 storage tank w/Nibe ELK-213 heater
FRESH WATER FILTERS	Dual Stage 5" x 20" particle and carbon
FRESH WATER HEATERS	1 x Nibe 200 ELK213, 53 gallons 2 x Grundfos circulating pumps
TOILETS	Jets Vacuum collection, 10 x Jets marine toilets
SEWAGE TREATMENT	Hamann Wassertechnik Mini L
OIL/WATER SEPARATOR	A Heli-Sep bilge oil/water separator OCD oil content meter in compliance w/ USCG/Marpol
FUEL SEPARATOR	Kaydon CF112, 12 GPM Coalescer filter
FUEL FILTERS	2 x Separ SWK2000/ 18/U water separator 2 x Separ SWK2000/5/50U water separator
FUEL OIL TRANSFER	1 x G&R ASV331, 26 GPD
OIL PUMPS	Oberdorfer

8. NAVIGATION EQUIPMENT

RADAR	Furuno / Arpa BB2127BB
GYROCOMPASS	Anschutz Digital gyro STD22 Simrad AP50 helm station fwd
MAGNETIC COMPASS	Sperry Marine Nortrop Grumman 2060 Anschutz repeater at helm station fwd
AUTOMATIC PILOT	Simrad AP50 Furuno MultiPurpose LCD display MU155C at helm station fwd
DEPTH SOUNDER	Furuno Colour LCD FCV1200L
GPS	Furuno Navigator GP170 at helm station fwd
CHART PLOTTER	Time Zero Professional
WIND INSTRUMENTS	B&G Wind H3000, repeater at helm station fwd Furuno RD33
SPEED LOG	Furuno Doppler Speed DS-80
NAVTEX	Furuno NX-700
AIS	Furuno Universal FA150
HELM CONTROL STATIONS	Helm Station Forward Deck Pilot House and sundeck remote

9. COMMUNICATION EQUIPMENT

SATCOM	Intellian V60
TELEPHONE SYSTEM	Panasonic PABX KXT7633B

Generated On 7/3/2023 9:10 AM by RoyalYacht Service

VHF FIXED	Furuno FM8800S
	Icom ICM604
VHF HANDHELD	2 x Icom
CELLULAR SYSTEM	Alarm/Cellular Phone Gost Apparition
INTERCOM	Furuno Loudhailer LH3000

10. **DECK EQUIPMENT**

ANCHORS	2 x Davis Pool type anchors HP400 316L s/s polished
ANCHOR CHAINS	2 x 360 feet galvanised 5/8" stud link Grade 2 chains
ANCHOR WINDLASS	2 x Ideal H9M horizontal windlass, 10Hp hydraulic 8,000lb pull
AFT WARPING CAPSTANS	2 x Muir VC4000
BOAT CRANE/DAVITS	1 x Nautical Structures EZ5500EX, 5,500 lbs SWL on boat deck
PASSARELLE	Nautical Structures Hydraulic, 7-steps portable
SIDE BOARDING	Cramm custom hydraulic load holding
STERN BOARDING	Nautical Structures hydraulic telescopic 20', slewing to 90 Port
GANGWAY	
SPOTLIGHT	1 x Carlisle & Finch
UNDERWATER LIGHTS	4 x Underwater lights
JACUZZI	Baja Spas on sun deck
PAINT SYSTEM	Exterior Awlgrip Mystique Blue & Snow White Interior Awlcraft White Underwater Seahawk Biocop TF, Prop Speed antifouling
LOUDHAILER	Horn Kahlenberg model F2, 5 x trumpets

11. **ENTERTAINMENT EQUIPMENT**

CENTRAL AUDIO SYSTEM	Crestron controlled central system Sat TV Intellian i6 28"
TV RECEIVERS	Dish Network 14 x Wally receivers
MAIN SALON	52" TV Samsung UHDTV (2019) with Crestron control Stereo 5:1 Surround Sound
MASTER CABIN	30" TV Sole with Crestron control 13-Pin iPhone Dock
VIP CABIN	32" TV Sole with Crestron control 13-Pin iPhone Dock
GUEST CABINS	2 x 22" TVs Sole with Crestron control 13-Pin iPhone Dock
SKY LOUNGE	24" TV Samsung
EXTERIOR	Stereo Sat TV audio aft deck and upper deck
CAPTAIN'S CABIN	19" TV Sole DVD Samsung Stereo Sound Craft

CREW MESS	32" TV Sole with Crestron control
CREW CABINS	12" TV Vision flip down TV/DVD combo Stereo Sound Craft

12. GALLEY & LAUNDRY EQUIPMENT

MAIN SALON BAR	1 x Ice Maker Hoshizaki, Mod AM-50BAJ, SN H12647L 1 x Refrigerator Sub Zero, Mod UC-24R, SN P2875739 1 x Basin
MAIN SERVICE	1 x Refrigerator Sub Zero, Mod UC-24R, SN P2875741 1 x Heat Lamps Hatco Glo Ray GRH-18 1 x Basin
AFT DECK	1 x Sub Zero Refrigerator UC-24R, SN P2806803
FORE DECK	1 x Refrigerator U-Line U-2115RW-00, SN 083284-07-0005
UPPER AFT DECK	1 x Sub Zero Refrigerator UC-24R, SN G3657723 1 x Sub Zero Ice Maker, UC-1510, SN 3881916
MAIN GALLEY	1 x Miele Oven 30" H6680BP, SN 09769460 1 x Miele Oven 24" H6560BP, SN 09769410 1 x GE Profile Range 5-burners 36" SS Refrigeration, walk-in Cospolich WIC Artic Safe, SN 256507 1 x Dishwasher Miele PG8080, SN 64/147316140 1 x Compactor Viking Professional VUC 181SS 1 x Microwave Oven Samsung 1 x Garbage Disposal InSinkErator Excel-4
CREW MESS	1 x GE Microwave JE0736SM1SS, SN VR913709U 1 x Sub Zero 2-drawer refrigerator Mod 700BR3, SN M2584869 2 x Cospolich Freezer 27.5"W x 33"D x42"H 1 x Perlick ice maker H50IMSL, SN E02716A 1 x Jura coffee Machine 1 x Toaster
LAUNDRY	1 x Miele Washer / Dryer Stacked Mod PT7136 Plus/PW6065 Vario, SN 40/66678314-40/69866304 1 x Basin
CREW LAUNDRY	1 x Miele Washer PT7136 Plus, SN 40/66742306 1 x Dryer Miele PW6065 Vario, SN 56/114924785

Generated On 7/3/2023 9:10 AM by RoyalYacht Service

13. SECURITY & SAFETY EQUIPMENT

SAFETY	2 x 16-person Viking life rafts 1 x 4-person Viking life raft 4 x 30" life rings (2 x with Smoke MK9) 2 x EBIRBS (ACR Cat 1 & McMurdo Cat 2) 3 x MK9 flares 6 x Red Parachute flares 12 x MK8 flares 1 x Line thrower 16 x Inflatable life jackets 10 x Life jackets 18 x Imperial immersion suits
FIRE FIGHTING	Fixed CO2 for Engine Room Notifier fire detection system Ansul CO2 system discharging in engine room 3 x Portable CO2 of 10lbs 19 x ABC Fire Extinguishers Simon Alarms / Monitoring
SECURITY	CCTV Pelco – Hard Drive Recording 7 x Pelco cameras 3 x Hatteland 19"X Monitors
SHIP'S SAFES	3 x AmeriSafe, Master/VIP/Stbd Guest 1 x Sentry Safe, Port Twin Guest 4 x Amsee, Crew Cabins
MEDICAL EQUIPMENT	1 x Medic Bag 1 x Defibrillator 1 x Oxygen Tank

14. TENDERS & WATERSPORTS EQUIPMENT

TENDERS	1 x Novurania CAT18 with 115 Hp Yamaha outboard (new 2019)
DIVING	2 x Dive Tanks

15. REFIT & MAINTENANCE NOTES

REFIT 2021:

- ABS - 15-year survey
- Hauled yacht, checked, and serviced overboard valves
- Pulled shafts and checked shaft seals
- Inspected all tanks and painted freshwater tank
- Varnish and paint touch-ups
- Polish hull
- Service main engines and generators
- All recommended service on other equipment
- Fitted protection against a lightning strike

MAJOR UPGRADES 2019:

- A skylounge was added with bathroom, featuring large windows, interior mahogany panels and tongue and groove panelling, painted gloss white, with teak and holly flooring, designed by Ken Freivokh, perfectly complements the original interior/exterior styling and finish, as well as the exterior profile of this classic yacht
- Shortened the carbon fibre mast and installed electronics, teak faux painted
- Added Crow's Nest and teak cladding all-around, under the upper deck's cap rail
- Added teak cap rail on the upper deck
- Added height to the forward flag mast
- Modified the aft deck seating layout with 2 x new sofas and 2 x tables
- Shortened the upper aft deck above the transom seat
- Redesigned the main salon with faux leather panels with wood design, custom art deco sofas, arm chairs and tables
- New Novurania CAT 18 tender with 115 Hp Yamaha
- New Air MakeUp AC Handler
- New insulation on AC lines in all accessible areas
- New AC/DC neutral ground fault systems
- 3 x New pilothouse 19" monitors
- New GPS Map/Radar 12"
- New Samsung UHD TV 52" in Salon

16. **COMMENTS**

The owner's passion for the classic and neoclassic style cruisers led him to NADAN and her transformation. His specific vision and attention to detail was implemented to attain the timeless elegance and charm of the 1920's. The new skylounge and crow's nest compliment the yacht's fluid lines and pleasing proportions while reflecting the same commitment to perfection. NADAN's shallow draft enables her to cruise the Bahamas and inland waterways, which is very difficult to find in a vessel of this design. NADAN is in immaculate condition.

KEY FEATURES

- Exquisite custom Burger quality
- 4 x Owners and guest staterooms
- Shallow 6 foot draft

Generated On 7/3/2023 9:10 AM by RoyalYacht Service

- Economical with transatlantic range
- Recent completed ABS special survey
- Zero speed stabilization

Generated On 7/3/2023 9:10 AM by RoyalYacht Service

Royal Yacht International

RoyalYacht Service
office@royalyacht.it
<https://royalyachtinternational.com/>

NADAN



Generated On 7/3/2023 9:10 AM by RoyalYacht Service

Royal Yacht International

RoyalYacht Service
office@royalyacht.it
<https://royalyachtinternational.com/>

NADAN





Generated On 7/3/2023 9:10 AM by RoyalYacht Service

Royal Yacht International

RoyalYacht Service
office@royalyacht.it
<https://royalyachtinternational.com/>

NADAN

Page 14 of 26



Generated On 7/3/2023 9:10 AM by RoyalYacht Service

Royal Yacht International

RoyalYacht Service
office@royalyacht.it
<https://royalyachtinternational.com/>

NADAN







Generated On 7/3/2023 9:10 AM by RoyalYacht Service

Royal Yacht International

RoyalYacht Service
office@royalyacht.it
<https://royalyachtinternational.com/>

NADAN



Generated On 7/3/2023 9:10 AM by RoyalYacht Service

Royal Yacht International

RoyalYacht Service
office@royalyacht.it
<https://royalyachtinternational.com/>

NADAN



Generated On 7/3/2023 9:10 AM by RoyalYacht Service

Royal Yacht International

RoyalYacht Service
office@royalyacht.it
<https://royalyachtinternational.com/>

NADAN



Generated On 7/3/2023 9:10 AM by RoyalYacht Service

Royal Yacht International

RoyalYacht Service
office@royalyacht.it
<https://royalyachtinternational.com/>

NADAN





Generated On 7/3/2023 9:10 AM by RoyalYacht Service

Royal Yacht International

RoyalYacht Service
office@royalyacht.it
<https://royalyachtinternational.com/>

NADAN



Generated On 7/3/2023 9:10 AM by RoyalYacht Service

Royal Yacht International

RoyalYacht Service
office@royalyacht.it
<https://royalyachtinternational.com/>

NADAN



Generated On 7/3/2023 9:10 AM by RoyalYacht Service

Royal Yacht International

RoyalYacht Service
office@royalyacht.it
<https://royalyachtinternational.com/>

NADAN



PROFILE

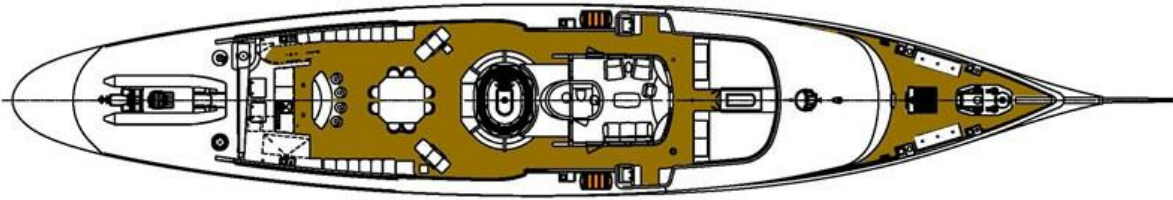

BRIDGE DECK

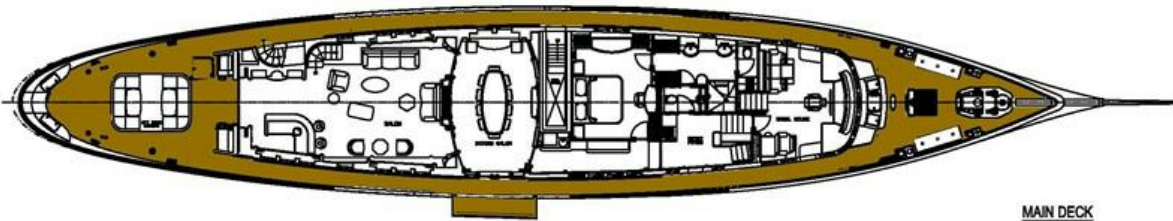

MAIN DECK

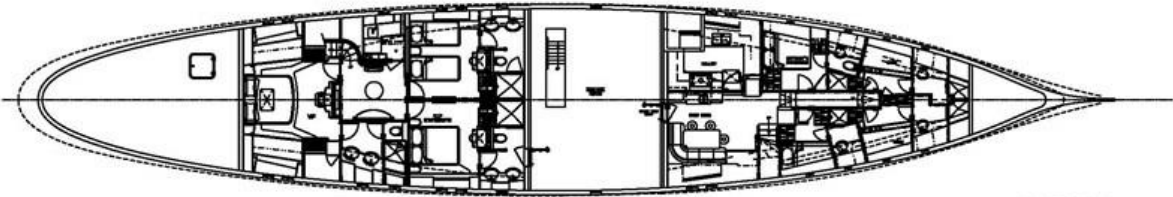

LOWER DECK